



# D BALAJI PIPE FITTINGS



*Quality With Integrity.*





## Company Profile

**D BALAJI PIPES & FITTINGS** is a well known Importers, Manufacturer, Stockiest, Supplier and Exporter of Raw materials like Long Radius Bends, Compression Tube Fittings, Pipe Fittings, Forged Fittings, Flanges, Shims & Plates, Fasteners, Pipes & Tubes, Round Bars & Wire, Flat Bars etc.

**D BALAJI PIPES & FITTINGS** And Has A Track Record Of Offering A Wide Range Of Piping Solution At Very Competitive Prices. In A Very Short Period Of Time, We Have Gained An Excellent National And International Reputation.

We Are Able To Satisfy The Needs Of Our Clients In A Timely And Systematic Manner. The Profound Knowledge And Rich Experience of Our Team in The Respective Arena Of Metal Products Has Assisted The Company To Acquire Distinguished Position Amidst The Reliable Piping Solutions in India & All Over World.

We Export 60% Of Our Range Of Flanges, Outlets, Pipe Fittings And Forged Fittings To Many Countries Like Europe, Saudi Arabia, Qatar, Australia, Brazil, UK, USA Etc. We Would Appreciate To Get Your Esteemed Enquires And Look Forward To The Pleasure Receiving Your Valuable Response.

We Are Regularly Supplying These Items To Many Leading Industrial Units Consisting Of : Ship Building, Petrochemical Plants, Steel Plants, Refineries, Chemicals, Fertilizers, Power Plant, Pharmaceutical, Ports, Oil & Gas, Railway, Mining, Cement Plants, Paper Mills, Sugar Mills, Fabrication Units Etc.

Especially Stainless Steel Sheets/ Plates/ Coils/ Pipes To Engineering Industries Who Are Engage In The Manufacture And Fabrication Of Process Equipment. We Can Supply The Items Even Under Third Party Inspection Viz Bureau Veritas, D.N.V., Kavernor Power Gas, Udhe India, EIL, Lloyds, Toyo, Chemtex, Ceil, Tecnimont, IBR Etc.

We hope the information provide is useful to you & will forward us your regular enquires and requirement & provide us with an opportunity to work with your esteemed organisation.

If you have any suggestion or query, on how we can serve you better please do inform us. Your suggestions are heartily welcomed.





# D BALAJI

## PIPE FITTINGS

HOUSE OF STAINLESS STEEL

### Manufacturers of :

Stainless Steel Pipe & Fittings, Butt Weld Fittings,  
Dairy Fittings, Socket Weld & Forge Fittings.

### Stockist, Dealers & Suppliers of :

Stainless Steel Pipe and Tubes (Seamless and Welded) Sheet,  
Plate, Coils, Rods, Angle, Channel, Valves, Perforate Sheets, Wire and  
Wiremesh Industrial Raw Materials in Ferrous & Non-ferrous Metals.

Old No. 202/232, Linghi Chetty Street, Shop No. 2 & 3, Chennai - 600 001.  
T/Fax: 044-2522 8081 \* P: 044-4216 2308 / 4215 9085

140, FF, Suvan Business Park, Nr. Kewal Kanta, Rakhial,  
Ahmedabad - 380 023. Mob.: 88255 29011

**Factory :** Pato Pandora Tatah Voki Rada Road, Magan Fest,  
Munchal, Maharashtra - 401 202.

**Call : +91 9962492282 / 98847 330542**

**Whatsapp : +91 9444522558 / 6374260316**

E-mail : [dbalajipipes2008@gmail.com](mailto:dbalajipipes2008@gmail.com) | [dbalajipurohit2008@yahoo.in](mailto:dbalajipurohit2008@yahoo.in)  
[internationaldbalaji2008@gmail.com](mailto:internationaldbalaji2008@gmail.com)

Web. : [www.dbpipefittings.in](http://www.dbpipefittings.in)





# Quality Policy



As per our corporate philosophy, we will always strive

- To improve the internal procedure control and to strengthen the communication and management.
- Make best of our effort to deliver high value added products to broaden the service scope.
- To promote wide variety of value added service and to make sure all customers requirements are met on time.
- Promoting technical skill to higher level and continuously putting the concept of "Quality that inspires the customer confidence".

## Vision

To become an enterprising organization in the field of Pipes and Tubes Products.  
To be Known for quality of products  
And Excellent Service

## Mission

To Satisfy our Clients needs by Providing High Quality Products at Competitive Price as per the Schedule and to Maintain long Term Relationship With our Clients

## Testing Facility Available

- Chemical Analysis
- Radiography
- Corrosion Test
- Hydrostatic
- Mechanical Test
- Ultrasonic Test

## Quality Assurance

We strive to deliver an unmatched quality range of Metal Products to our clients. We bring out the best of us to achieve the utmost quality standards. There is a team of quality auditors, who put in lots to bring forth a qualitative range of products, which is in adherence to the global quality standards. They make these products to pass through rigorous quality tests, so as to avoid the chance of any defect in our product range. Our products are tested on various internationally accepted parameters, which are as follows :

- » Durability
- » Strength
- » Wear & Tear Resistance
- » Corrosion Resistance
- » Malleability and Ductility





## BUTT-WELD FITTINGS

### Stainless Steel & Duplex Steel

- Stainless Steel : ASTM A 403 WP - 304/304H304L/316/316H  
316/316Ti, 309, 310, 317L, 321, 347, 904L
- Duplex & Super Duplex : Standard  
ASTM A815 - UNS S31803, S32205 (2205)  
Lean  
ASTM A 815, 790 - UNS S32304 (2304)  
Super Duplex  
ASTM A815 790 - UNS S32750 (2507)  
UNS S32760 (Zeron 100)

### Hi-Nickel & Titanium

#### Hi-Nickel

- Nickel : ASTM B 366 N02200, N02201
- Inconel : ASTM B 366 N06600, N06601, N06617  
ASTM B 366 N07718, ASTM B 366 N06625
- Incoloy : ASTM B 366 N08800, N08810  
ASTM B 366 N08825, ASTM B 366 N08020
- Hastelloy : ASTM B 366 N10276, N06022  
ASTM B366 N10665, ASTM B 366 N06455

#### Titanium

- Commercially : ASTM B 363
- Titanium Pure : Gr.1 R 56250 (CP4) Gr.2 R 50400 (CP3)  
Gr.3 R 50550 (Cp2) Gr.4 R 50700 (Cp1)  
Gr.7 R 52400 Gr.11 R 52250
- Titanium Alloys : ASTM B 363  
Gr.5 R 56400 (6Al-4V)  
Gr.23 R 56401 (6Al-4V-ELI)  
Gr.12 R 53400

### Cupro Nickel

- ASTM B 466 C70600 (90:10), ASTM B 466 C71500 (70:30)

### Monel

- ASTM B 366 N04400, DIN N05500

### Alloy Steel, Carbon Steel & LTCS

- Alloy Steel : ASTM A 234 WPB WP 5, WP 9, WP 11,  
WP 12, WP 22, WP 91
- Carbon Steel : ASTM A234 WPB, IS 1239 PART II
- Low Temp. CS : ASTM A-420 WPL6
- Other Service : Hot Dip Galvanizing, Sand Blasting

### Size

- Fittings : Seamless 15NB To 600NB  
Split / Welded 100NB To 1200NB
- Schedule : Sch. 5 to Sch. XXS

### Types

- Stubend - (Long & Short) Elbow (45 DEG, 90 DEG, 180 DEG)
- U Bend Tee - (Barred, Equal, Reducing)
- End Cap Reducer - (Concentric & Eccentric)
- Laterals Nipple - (swage & Barrel)

### Test Certificate

- Manufacturer Test Certification (En 3.1 & 3.2, IBR Test Certificate)

### Specializing in :

#### Hi-Nickel & Stainless Steel Series

- Inconel®, Incoloy®, Monel®, Hastelloy®, Duplex®,  
are Registered Trade Marks of their Respective Owners.





**DIMENSIONS OF BUTT-WELDING FITTING ANSI B-16.9 / B-16.28 / MSS SP 43**

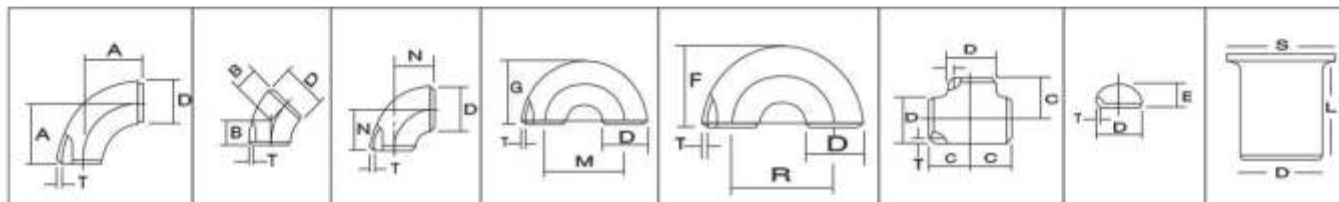

90 Elbow Long Radius    45 Elbow    90 Elbow Short Radius    180 Return Short Radius    180 Return Long Radius    Tee Equal Tee    Caps    Stub-End

| Nominal Pipe Size |     | Outside Diameter | Center to Face |       |       |           | Back to Face |        |       | Center to Center |        |       | Length 'L' |        |
|-------------------|-----|------------------|----------------|-------|-------|-----------|--------------|--------|-------|------------------|--------|-------|------------|--------|
| INCH              | MM  | D                | A<br>R=1.5D    | B     | C     | N<br>R=1D | E            | F      | G     | R                | M      | S     | Short L    | Long L |
| 1/2               | 15  | 21.3             | 38.00          | 16.0  | 25.0  | -         | 25.0         | 48.0   | -     | 76.0             |        | 35.0  | 50.8       | 76.2   |
| 3/4               | 20  | 26.7             | 29.00          | 11.0  | 29.0  | -         | 25.0         | 43.0   | -     | 57.0             |        | 43.0  | 50.8       | 76.2   |
| 1                 | 25  | 33.4             | 38.00          | 22.0  | 38.0  | 25.0      | 38.0         | 56.0   | 41.0  | 76.0             | 51.0   | 51.0  | 50.8       | 101.6  |
| 1.1/4             | 32  | 42.2             | 48.00          | 25.0  | 48.0  | 32.0      | 38.0         | 70.0   | 52.0  | 95.0             | 64.0   | 64.0  | 50.8       | 101.6  |
| 1.1/2             | 40  | 48.3             | 57.15          | 29.0  | 57.0  | 38.0      | 38.0         | 83.0   | 62.0  | 114.0            | 76.0   | 73.0  | 50.8       | 101.6  |
| 2                 | 50  | 60.3             | 76.00          | 35.0  | 64.0  | 51.0      | 38.0         | 106.0  | 81.0  | 152.0            | 102.0  | 93.0  | 63.5       | 152.4  |
| 2.1/2             | 65  | 73.0             | 95.25          | 44.0  | 76.0  | 64.0      | 38.0         | 132.0  | 100.0 | 191.0            | 127.0  | 105.0 | 63.5       | 152.4  |
| 3                 | 80  | 88.9             | 114.30         | 51.0  | 86.0  | 76.0      | 51.0         | 159.0  | 121.0 | 229.0            | 152.0  | 127.0 | 63.5       | 152.4  |
| 3.1/2             | 90  | 101.6            | 133.35         | 57.0  | 95.0  | 89.0      | 64.0         | 184.0  | 140.0 | 267.0            | 178.0  | 140.0 | 76.2       | 152.4  |
| 4                 | 100 | 114.3            | 152.0          | 64.0  | 105.0 | 102.0     | 64.0         | 210.0  | 159.0 | 305.0            | 203.0  | 157.0 | 76.2       | 152.4  |
| 5                 | 125 | 141.3            | 190.0          | 79.0  | 123.0 | 127.0     | 76.0         | 262.0  | 197.0 | 381.0            | 254.0  | 186.0 | 76.2       | 203.2  |
| 6                 | 150 | 168.3            | 229.0          | 95.0  | 143.0 | 152.0     | 89.0         | 313.0  | 237.0 | 457.0            | 305.0  | 218.0 | 88.9       | 203.2  |
| 8                 | 200 | 219.1            | 305.0          | 127.0 | 178.0 | 203.0     | 102.0        | 414.0  | 313.0 | 610.0            | 406.0  | 270.0 | 101.6      | 203.2  |
| 10                | 250 | 273.1            | 381.0          | 159.0 | 216.0 | 254.0     | 127.0        | 515.0  | 391.0 | 762.0            | 508.0  | 324.0 | 127.0      | 254.0  |
| 12                | 300 | 323.8            | 457.0          | 190.0 | 254.0 | 305.0     | 152.0        | 619.0  | 467.0 | 914.0            | 610.0  | 381.0 | 152.4      | 254.0  |
| 14                | 350 | 355.6            | 533.0          | 222.0 | 279.0 | 356.0     | 165.0        | 711.0  | 533.0 | 1067.0           | 711.0  | 413.0 | 152.4      | 305.0  |
| 16                | 400 | 406.4            | 610.0          | 254.0 | 305.0 | 406.0     | 178.0        | 813.0  | 610.0 | 1219.0           | 813.0  | 470.0 | 152.4      | 305.0  |
| 18                | 450 | 457.2            | 686.0          | 286.0 | 343.0 | 457.0     | 203.0        | 914.0  | 686.0 | 1372.0           | 914.0  | 533.0 | 152.4      | 305.0  |
| 20                | 500 | 508.0            | 762.0          | 318.0 | 381.0 | 508.0     | 229.0        | 1016.0 | 762.0 | 1524.0           | 1016.0 | 584.0 | 152.4      | 305.0  |
| 22                | 550 | 559.0            | 838.0          | 343.0 | 419.0 | 559.0     | 254.0        | 1118.0 | 838.0 | 1676.0           | 1118.0 | 614.4 | 152.4      | 305.0  |
| 24                | 600 | 610.0            | 914.0          | 381.0 | 432.0 | 610.0     | 267.0        | 1219.0 | 914.0 | 1829.0           | 1219.0 | 692.0 | 152.4      | 305.0  |
| 26                | 650 | 660.0            | 991.0          | 405.0 | 495.0 | 660.0     | 267.0        |        |       |                  |        |       |            |        |
| 28                | 700 | 711.0            | 1067.0         | 438.0 | 521.0 | 771.0     | 267.0        |        |       |                  |        |       |            |        |
| 30                | 750 | 762.0            | 1143.0         | 470.0 | 559.0 | 762.0     | 267.0        |        |       |                  |        |       |            |        |
| 32                | 800 | 813.0            | 1219.0         | 502.0 | 597.0 | 813.0     | 267.0        |        |       |                  |        |       |            |        |
| 34                | 850 | 864.0            | 1295.0         | 533.0 | 635.0 | 864.0     | 267.0        |        |       |                  |        |       |            |        |
| 36                | 900 | 914.4            | 1372.0         | 565.0 | 673.0 | 914.0     | 267.0        |        |       |                  |        |       |            |        |

All Dimensions in Millimeters





**DIMENSIONS OF BUTT-WELDING FITTING ANSI B-16.9 / B-16.28**

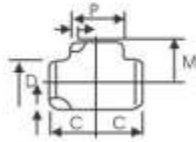

REDUCING TEES

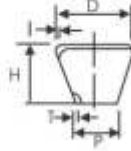

CONCENTRIC REDUCERS

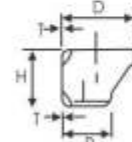

ECCENTRIC REDUCERS

| Nominal Pipe Size |           | Outside Diameter |       | Center to End |     | Length |
|-------------------|-----------|------------------|-------|---------------|-----|--------|
| INCH              | MM        | D                | P     | C             | M   | H      |
| 1/2 x 3/8         | 15 x 10   | 21.3             | 17.1  | 25            | 25  | -      |
| 1/2 x 1/4         | 15 x 8    | 21.3             | 13.7  | 25            | 25  | -      |
| 3/4 x 1/2         | 20 x 15   | 26.7             | 21.3  | 29            | 29  | 38     |
| 3/4 x 3/8         | 20 x 10   | 26.7             | 17.1  | 29            | 29  | 38     |
| 1 x 3/4           | 25 x 20   | 33.4             | 26.7  | 38            | 38  | 51     |
| 1 x 1/2           | 25 x 15   | 33.4             | 21.3  | 38            | 38  | 51     |
| 1 1/4 x 1         | 32 x 25   | 42.2             | 33.4  | 48            | 48  | 51     |
| 1 1/4 x 3/4       | 32 x 20   | 42.2             | 26.7  | 48            | 48  | 51     |
| 1 1/4 x 1/2       | 32 x 15   | 42.2             | 21.3  | 48            | 48  | 51     |
| 1 1/2 x 1 1/4     | 40 x 32   | 48.3             | 42.2  | 57            | 57  | 64     |
| 1 1/2 x 1         | 40 x 25   | 48.3             | 33.4  | 57            | 57  | 64     |
| 1 1/2 x 3/4       | 40 x 20   | 48.3             | 26.7  | 57            | 57  | 64     |
| 1 1/2 x 1/2       | 40 x 15   | 48.3             | 21.3  | 57            | 57  | 64     |
| 2 x 1 1/2         | 50 x 40   | 60.3             | 48.3  | 64            | 60  | 76     |
| 2 x 1 1/4         | 50 x 32   | 60.3             | 42.2  | 64            | 57  | 76     |
| 2 x 1             | 50 x 25   | 60.3             | 33.4  | 64            | 51  | 76     |
| 2 x 3/4           | 50 x 20   | 60.3             | 26.7  | 64            | 44  | 76     |
| 2 1/2 x 2         | 65 x 50   | 73.0             | 60.3  | 76            | 70  | 89     |
| 2 1/2 x 1 1/2     | 65 x 40   | 73.0             | 48.3  | 76            | 67  | 89     |
| 2 1/2 x 1 1/4     | 65 x 32   | 73.0             | 42.2  | 76            | 64  | 89     |
| 2 1/2 x 1         | 65 x 25   | 73.0             | 33.4  | 76            | 57  | 89     |
| 3 x 2 1/2         | 80 x 65   | 88.9             | 73.0  | 86            | 83  | 89     |
| 3 x 2             | 80 x 50   | 88.9             | 60.3  | 86            | 76  | 89     |
| 3 x 1 1/2         | 80 x 40   | 88.9             | 48.3  | 86            | 73  | 89     |
| 3 x 1 1/4         | 80 x 32   | 88.9             | 42.2  | 86            | 70  | 89     |
| 4 x 3 1/2         | 100 x 90  | 114.3            | 101.6 | 105           | 102 | 102    |
| 4 x 3             | 100 x 80  | 114.3            | 88.9  | 105           | 98  | 102    |
| 4 x 2 1/2         | 100 x 65  | 114.3            | 73.0  | 105           | 95  | 102    |
| 4 x 2             | 100 x 50  | 114.3            | 60.3  | 105           | 89  | 102    |
| 4 x 1 1/2         | 100 x 40  | 114.3            | 48.3  | 105           | 86  | 102    |
| 5 x 4             | 125 x 100 | 141.3            | 114.3 | 124           | 117 | 127    |
| 5 x 3 1/2         | 125 x 90  | 141.3            | 101.6 | 124           | 114 | 127    |
| 5 x 3             | 125 x 80  | 141.3            | 88.9  | 124           | 111 | 127    |
| 5 x 2 1/2         | 125 x 65  | 141.3            | 73.0  | 124           | 108 | 127    |
| 5 x 2             | 125 x 50  | 141.3            | 60.3  | 124           | 105 | 127    |
| 6 x 5             | 150 x 125 | 168.3            | 141.3 | 143           | 137 | 140    |
| 6 x 4             | 150 x 100 | 168.3            | 114.3 | 143           | 130 | 140    |
| 6 x 3 1/2         | 150 x 90  | 168.3            | 101.6 | 143           | 127 | 140    |
| 6 x 3             | 150 x 80  | 168.3            | 88.9  | 143           | 124 | 140    |
| 6 x 2 1/2         | 150 x 65  | 168.3            | 73.0  | 143           | 121 | 140    |

All Dimensions in Millimeters

| Nominal Pipe Size |           | Outside Diameter |       | Center to End |     | Length |
|-------------------|-----------|------------------|-------|---------------|-----|--------|
| INCH              | MM        | D                | P     | C             | M   | H      |
| 8 x 6             | 200x150   | 219.1            | 168.3 | 178           | 168 | 152    |
| 8 x 5             | 200 x 125 | 219.1            | 141.3 | 178           | 162 | 152    |
| 8 x 4             | 200 x 100 | 219.1            | 114.3 | 178           | 156 | 152    |
| 8 x 3 1/2         | 200 x 90  | 219.1            | 101.6 | 178           | 152 | 152    |
| 10 x 8            | 250 x 200 | 273.1            | 219.1 | 216           | 203 | 178    |
| 10 x 6            | 250 x 150 | 273.1            | 168.1 | 216           | 194 | 178    |
| 10 x 5            | 250 x 125 | 273.1            | 141.3 | 216           | 191 | 178    |
| 10 x 4            | 250 x 100 | 273.1            | 114.3 | 216           | 184 | 178    |
| 12 x 10           | 300 x 250 | 323.9            | 273.1 | 254           | 241 | 203    |
| 12 x 8            | 300 x 200 | 323.9            | 219.1 | 254           | 229 | 203    |
| 12 x 6            | 300 x 150 | 323.9            | 168.3 | 254           | 219 | 203    |
| 12 x 5            | 300 x 125 | 323.9            | 141.3 | 254           | 216 | 203    |
| 14 x 12           | 350 x 300 | 355.6            | 323.9 | 279           | 270 | 330    |
| 14 x 10           | 350 x 250 | 355.6            | 273.1 | 279           | 257 | 330    |
| 14 x 8            | 350 x 200 | 355.6            | 219.1 | 279           | 248 | 330    |
| 14 x 6            | 350 x 150 | 355.6            | 168.3 | 279           | 238 | 330    |
| 16 x 14           | 400 x 350 | 406.4            | 355.6 | 305           | 305 | 356    |
| 16 x 12           | 400 x 300 | 406.4            | 323.9 | 305           | 295 | 356    |
| 16 x 10           | 400 x 250 | 406.4            | 273.1 | 305           | 283 | 356    |
| 16 x 8            | 400 x 200 | 406.4            | 219.1 | 305           | 273 | 356    |
| 16 x 6            | 400 x 150 | 406.4            | 168.3 | 305           | 264 | 356    |
| 18 x 16           | 450 x 400 | 457.0            | 406.4 | 343           | 330 | 381    |
| 18 x 14           | 450 x 350 | 457.0            | 355.6 | 343           | 330 | 381    |
| 18 x 12           | 450 x 300 | 457.0            | 323.9 | 343           | 321 | 381    |
| 18 x 10           | 450 x 250 | 457.0            | 273.1 | 343           | 308 | 381    |
| 18 x 8            | 450 x 200 | 457.0            | 219.1 | 343           | 298 | 381    |
| 20 x 18           | 500 x 450 | 508.0            | 457.0 | 381           | 368 | 508    |
| 20 x 16           | 500 x 400 | 508.0            | 406.4 | 381           | 356 | 508    |
| 20 x 14           | 500 x 350 | 508.0            | 355.6 | 381           | 356 | 508    |
| 20 x 12           | 500 x 300 | 508.0            | 323.9 | 381           | 346 | 508    |
| 20 x 10           | 500 x 250 | 508.0            | 273.1 | 381           | 333 | 508    |
| 20 x 8            | 500 x 200 | 508.0            | 219.1 | 381           | 324 | 508    |
| 24 x 22           | 600 x 550 | 610.0            | 559.0 | 432           | 432 | 508    |
| 24 x 20           | 600 x 500 | 610.0            | 508.0 | 432           | 432 | 508    |
| 24 x 18           | 600 x 450 | 610.0            | 457.0 | 432           | 419 | 508    |
| 24 x 16           | 600 x 400 | 610.0            | 406.4 | 432           | 406 | 508    |
| 24 x 14           | 600 x 350 | 610.0            | 355.6 | 432           | 406 | 508    |
| 24 x 12           | 600 x 300 | 610.0            | 323.9 | 432           | 397 | 508    |
| 24 x 10           | 600 x 250 | 610.0            | 273.1 | 432           | 384 | 508    |



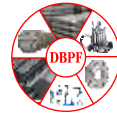

## FLANGES

### **Stainless Steel & Duplex Steel**

Stainless Steel : ASTM A 182F - 304/304H/304L/316/316H/316/316Ti  
309, 310, 317L, 321, 347, 904L

Duplex & Super Duplex : ASTM A182 - F51, F53, F55

### **Hi-Nickel & Titanium**

#### **Hi-Nickel**

Nickel : ASTM B 564 N02200, N02201

Inconel : ASTM B 564 N06600, N06601, N06617  
ASTM B 564 N07718, ASTM B 564 N06625

Incoloy : ASTM B 564 N08800, N08810  
ASTM B 564, N08825, ASTM B 564 N08020

Hastelloy : ASTM B 564 N10276, N06022  
ASTM B 564 N10665, ASTM B 564 N06455

#### **Titanium**

Commercially : ASTM B 381 - Gr.1 R 56250 (CP4)

Titanium Pure : Gr.2 R 50400 (CP3) Gr.3 R 50550 (CP2)  
Gr.4 R 50700 (CP1) Gr.7 R 52400  
Gr.11 R 52250

Titanium Alloys : ASTM B 381 - Gr.5 R 56400 (6Al-4V)  
Gr.23 R 56401 (6Al-4V-ELI)  
Gr.12 R 53400

#### **Cupro Nickel**

ASTM B 151 C70600 (90:10), ASTM B 151 C71500 (70:30)

### **Monel**

ASTM B 564 - N04400, N05500

### **Alloy Steel, Carbon Steel**

Alloy Steel : ASTM A 182 F 5, F 9, F 11,  
F 12, F 22, F 91

Carbon Steel : A105

Low Temp. CS : ASTM A - 350 LF2

### **Size**

15NB To 1200NB, ANSI B 16.5

### **Class**

150#, 300#, 600#, 900#, 1500#, 2500#

### **Types**

|            |                    |
|------------|--------------------|
| Weldneck   | Screwed / Threaded |
| Socketweld | Long Weldneck      |
| Slip on    | Lapped Joint       |
| Blind      | Spectacle Blind    |

### **Test Certificate**

Manufacturer Test Certification (En 3.1 & 3.2, IBR Test Certificate)

### **Specializing in :**

#### **Hi-Nickel & Stainless Steel Series**

Inconel®, Incoloy®, Monel®, Hastelloy®, Duplex®, are Registered Trade Marks of their Respective Owners.





**FORGED FLANGES DIMENSIONS**

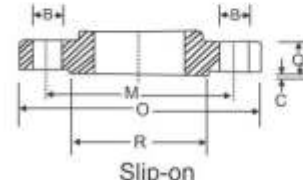
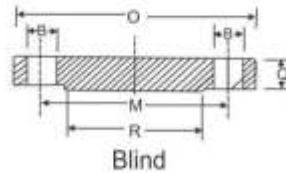
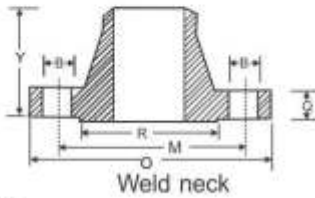

150 lbs

300 lbs

| Normal pipe size (in mm) | Outside dia of flange | Minimum thickness of flange | Overall Length |                          |           | bolt circle | No. and size of holes |    |     | O D of Raised face |
|--------------------------|-----------------------|-----------------------------|----------------|--------------------------|-----------|-------------|-----------------------|----|-----|--------------------|
|                          |                       |                             | Welding neck   | slip-on & socket welding | Lap joint |             | No.                   | B  | R   |                    |
|                          | O                     | Q                           | Y              |                          |           | Dia.m       | No.                   | B  | R   |                    |
| 15                       | 89                    | 11.2                        | 47.6           | 15.9                     | 15.9      | 60.5        | 4                     | 15 | 35  |                    |
| 20                       | 96                    | 12.7                        | 52.4           | 15.9                     | 15.9      | 70.0        | 4                     | 15 | 43  |                    |
| 25                       | 108                   | 14.3                        | 55.6           | 17.5                     | 17.5      | 79.5        | 4                     | 15 | 51  |                    |
| 32                       | 117                   | 15.9                        | 57.2           | 20.6                     | 20.6      | 89.0        | 4                     | 15 | 64  |                    |
| 40                       | 127                   | 17.5                        | 61.9           | 22.2                     | 22.2      | 98.5        | 4                     | 15 | 73  |                    |
| 50                       | 152                   | 19.1                        | 63.5           | 25.4                     | 25.4      | 120.5       | 4                     | 19 | 92  |                    |
| 65                       | 178                   | 22.3                        | 69.8           | 28.6                     | 28.6      | 139.5       | 4                     | 19 | 105 |                    |
| 80                       | 190                   | 23.9                        | 69.8           | 30.2                     | 30.2      | 152.5       | 4                     | 19 | 127 |                    |
| 90                       | 216                   | 23.9                        | 71.4           | 31.8                     | 31.8      | 178.0       | 8                     | 19 | 140 |                    |
| 100                      | 229                   | 23.9                        | 76.2           | 33.3                     | 33.3      | 190.5       | 8                     | 19 | 157 |                    |
| 125                      | 254                   | 23.9                        | 88.9           | 36.5                     | 36.5      | 216.0       | 8                     | 22 | 186 |                    |
| 150                      | 279                   | 25.4                        | 88.9           | 39.7                     | 39.7      | 241.5       | 8                     | 22 | 216 |                    |
| 200                      | 343                   | 28.6                        | 101.6          | 44.4                     | 44.4      | 298.5       | 8                     | 22 | 270 |                    |
| 250                      | 406                   | 30.2                        | 101.6          | 49.2                     | 49.2      | 362.0       | 12                    | 25 | 324 |                    |
| 300                      | 483                   | 31.8                        | 114.3          | 55.6                     | 55.6      | 432.0       | 12                    | 25 | 381 |                    |
| 350                      | 533                   | 35.0                        | 127.0          | 57.2                     | 79.4      | 476.0       | 12                    | 29 | 413 |                    |
| 400                      | 597                   | 36.6                        | 127.0          | 63.5                     | 87.3      | 539.5       | 16                    | 29 | 470 |                    |
| 450                      | 635                   | 39.7                        | 139.7          | 68.3                     | 96.8      | 578.0       | 16                    | 32 | 533 |                    |
| 500                      | 698                   | 42.9                        | 144.5          | 73.0                     | 103.2     | 635.0       | 20                    | 32 | 584 |                    |
| 600                      | 813                   | 47.7                        | 152.4          | 82.6                     | 111.1     | 749.5       | 20                    | 35 | 692 |                    |

| Normal pipe size (in mm) | Outside dia of flange | Minimum thickness of flange | Overall Length |                          |           | bolt circle | No. and size of holes |    |     | O D of Raised face |
|--------------------------|-----------------------|-----------------------------|----------------|--------------------------|-----------|-------------|-----------------------|----|-----|--------------------|
|                          |                       |                             | Welding neck   | slip-on & socket welding | Lap joint |             | No.                   | B  | R   |                    |
|                          | O                     | Q                           | Y              |                          |           | Dia.m       | No.                   | B  | R   |                    |
| 15                       | 95                    | 14.3                        | 52.4           | 22.2                     | 22.2      | 66.5        | 4                     | 15 | 35  |                    |
| 20                       | 117                   | 15.9                        | 57.2           | 25.4                     | 25.4      | 82.5        | 4                     | 19 | 43  |                    |
| 25                       | 124                   | 17.5                        | 61.9           | 27.0                     | 27.0      | 89.5        | 4                     | 19 | 51  |                    |
| 32                       | 133                   | 19.1                        | 65.1           | 27.0                     | 27.0      | 98.5        | 4                     | 19 | 64  |                    |
| 40                       | 156                   | 20.7                        | 66.3           | 30.2                     | 30.2      | 114.5       | 4                     | 22 | 73  |                    |
| 50                       | 165                   | 22.3                        | 69.8           | 33.3                     | 33.3      | 127.0       | 8                     | 19 | 92  |                    |
| 65                       | 190                   | 25.4                        | 76.2           | 38.1                     | 38.1      | 149.0       | 8                     | 22 | 105 |                    |
| 80                       | 210                   | 28.6                        | 79.4           | 42.9                     | 42.9      | 168.0       | 8                     | 22 | 127 |                    |
| 90                       | 229                   | 30.2                        | 81.0           | 44.5                     | 44.5      | 184.0       | 8                     | 22 | 140 |                    |
| 100                      | 254                   | 31.8                        | 85.7           | 47.6                     | 47.6      | 200.0       | 8                     | 22 | 157 |                    |
| 125                      | 279                   | 35.0                        | 98.4           | 50.8                     | 50.8      | 235.0       | 8                     | 22 | 186 |                    |
| 150                      | 313                   | 36.6                        | 98.4           | 52.4                     | 52.4      | 270.0       | 12                    | 22 | 216 |                    |
| 200                      | 381                   | 41.3                        | 111.1          | 61.9                     | 61.9      | 330.0       | 12                    | 25 | 270 |                    |
| 250                      | 444                   | 47.7                        | 117.5          | 66.7                     | 95.3      | 387.5       | 16                    | 29 | 324 |                    |
| 300                      | 521                   | 50.8                        | 130.2          | 73.0                     | 101.6     | 451.0       | 16                    | 32 | 381 |                    |
| 350                      | 584                   | 54.0                        | 142.9          | 76.2                     | 111.1     | 514.5       | 20                    | 32 | 413 |                    |
| 400                      | 648                   | 57.2                        | 146.0          | 82.6                     | 120.7     | 571.5       | 20                    | 35 | 470 |                    |
| 450                      | 711                   | 60.4                        | 158.8          | 88.9                     | 130.2     | 628.5       | 24                    | 35 | 584 |                    |
| 500                      | 775                   | 63.5                        | 161.9          | 95.2                     | 139.7     | 686.0       | 24                    | 35 | 692 |                    |
| 600                      | 914                   | 69.9                        | 168.3          | 106.4                    | 152.4     | 813.0       | 24                    | 41 | 692 |                    |

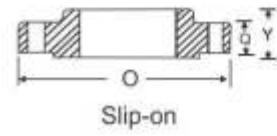
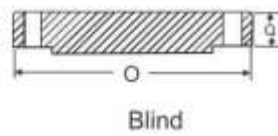
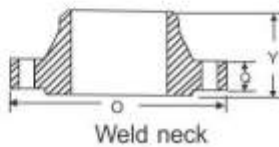

600 lbs

900 lbs

| Normal pipe size (in mm) | Outside dia of flange | Minimum thickness of flange | Overall Length |                          |           | bolt circle | No. and size of holes |    |     | O D of Raised face |
|--------------------------|-----------------------|-----------------------------|----------------|--------------------------|-----------|-------------|-----------------------|----|-----|--------------------|
|                          |                       |                             | Welding neck   | slip-on & socket welding | Lap joint |             | No.                   | B  | R   |                    |
|                          | O                     | Q                           | Y              |                          |           | Dia.m       | No.                   | B  | R   |                    |
| 15                       | 95                    | 14.3                        | 52.4           | 22.2                     | 22.2      | 66.5        | 4                     | 15 | 35  |                    |
| 20                       | 117                   | 15.9                        | 57.2           | 25.4                     | 25.4      | 82.5        | 4                     | 19 | 43  |                    |
| 25                       | 124                   | 17.5                        | 61.9           | 27.0                     | 27.0      | 89.5        | 4                     | 19 | 51  |                    |
| 32                       | 133                   | 20.7                        | 66.7           | 28.6                     | 28.5      | 98.5        | 4                     | 19 | 64  |                    |
| 40                       | 156                   | 22.3                        | 69.8           | 31.8                     | 31.8      | 114.5       | 4                     | 22 | 73  |                    |
| 50                       | 165                   | 25.4                        | 73.0           | 36.5                     | 36.5      | 127.0       | 8                     | 19 | 92  |                    |
| 65                       | 190                   | 28.6                        | 79.4           | 41.3                     | 41.3      | 149.0       | 8                     | 22 | 105 |                    |
| 80                       | 210                   | 31.8                        | 82.6           | 46.0                     | 46.0      | 168.0       | 8                     | 22 | 127 |                    |
| 90                       | 229                   | 35.0                        | 85.7           | 49.2                     | 49.2      | 184         | 8                     | 25 | 140 |                    |
| 100                      | 273                   | 38.1                        | 101.6          | 54.0                     | 54.0      | 216.0       | 8                     | 25 | 157 |                    |
| 125                      | 330                   | 44.5                        | 114.3          | 60.3                     | 60.3      | 266.5       | 8                     | 29 | 186 |                    |
| 150                      | 356                   | 47.7                        | 117.5          | 66.7                     | 66.7      | 292.0       | 12                    | 29 | 216 |                    |
| 200                      | 419                   | 55.6                        | 133.4          | 76.2                     | 76.2      | 349.0       | 12                    | 32 | 270 |                    |
| 250                      | 508                   | 63.5                        | 152.4          | 85.7                     | 115.1     | 432.0       | 16                    | 35 | 324 |                    |
| 300                      | 559                   | 66.7                        | 155.6          | 92.1                     | 111.1     | 489.0       | 20                    | 35 | 381 |                    |
| 350                      | 603                   | 69.9                        | 165.1          | 93.7                     | 117.5     | 527.0       | 20                    | 38 | 413 |                    |
| 400                      | 686                   | 76.2                        | 177.8          | 106.4                    | 127.0     | 603.0       | 20                    | 41 | 470 |                    |
| 450                      | 743                   | 82.6                        | 184.2          | 117.6                    | 139.7     | 654.0       | 20                    | 45 | 533 |                    |
| 500                      | 813                   | 88.9                        | 190.5          | 127.0                    | 165.1     | 724.0       | 24                    | 45 | 584 |                    |
| 600                      | 940                   | 101.6                       | 203.2          | 139.7                    | 184.2     | 838.0       | 24                    | 51 | 692 |                    |

| Normal pipe size (in mm) | Outside dia of flange | Minimum thickness of flange | Overall Length |                          |           | bolt circle | No. and size of holes |    |     | O D of Raised face |
|--------------------------|-----------------------|-----------------------------|----------------|--------------------------|-----------|-------------|-----------------------|----|-----|--------------------|
|                          |                       |                             | Welding neck   | slip-on & socket welding | Lap joint |             | No.                   | B  | R   |                    |
|                          | O                     | Q                           | Y              |                          |           | Dia.m       | No.                   | B  | R   |                    |
| 15                       | 121                   | 22.3                        | 60.3           | 31.8                     | 31.8      | 82.5        | 4                     | 22 | 35  |                    |
| 20                       | 130                   | 25.4                        | 69.8           | 34.9                     | 34.9      | 89.0        | 4                     | 22 | 43  |                    |
| 25                       | 149                   | 28.6                        | 73.0           | 41.3                     | 41.3      | 101.5       | 4                     | 25 | 51  |                    |
| 32                       | 159                   | 28.6                        | 73.0           | 41.3                     | 41.3      | 111.0       | 4                     | 25 | 64  |                    |
| 40                       | 178                   | 31.8                        | 82.6           | 44.4                     | 44.4      | 124.0       | 4                     | 29 | 73  |                    |
| 50                       | 216                   | 38.1                        | 101.6          | 57.2                     | 57.2      | 165.0       | 8                     | 25 | 92  |                    |
| 65                       | 244                   | 41.3                        | 104.8          | 63.5                     | 63.5      | 190.5       | 8                     | 29 | 105 |                    |
| 80                       | 241                   | 38.1                        | 101.6          | 54.0                     | 54.0      | 190.5       | 8                     | 25 | 127 |                    |
| 100                      | 292                   | 44.5                        | 114.3          | 69.8                     | 69.8      | 235.0       | 8                     | 32 | 157 |                    |
| 125                      | 349                   | 50.8                        | 127.0          | 79.4                     | 79.4      | 279.5       | 8                     | 35 | 186 |                    |
| 150                      | 381                   | 55.6                        | 139.7          | 85.7                     | 85.7      | 317.5       | 12                    | 32 | 216 |                    |
| 200                      | 470                   | 68.5                        | 161.5          | 101.8                    | 114.3     | 393.5       | 12                    | 38 | 270 |                    |
| 250                      | 546                   | 69.9                        | 184.2          | 108.0                    | 127.0     | 470.0       | 16                    | 38 | 324 |                    |
| 300                      | 610                   | 79.4                        | 200.0          | 117.5                    | 142.9     | 533.5       | 20                    | 38 | 381 |                    |
| 350                      | 641                   | 85.8                        | 212.7          | 130.2                    | 155.6     | 559.0       | 20                    | 41 | 413 |                    |
| 400                      | 705                   | 88.9                        | 215.8          | 133.4                    | 165.1     | 616.0       | 20                    | 45 | 470 |                    |
| 450                      | 787                   | 101.6                       | 228.6          | 152.4                    | 190.5     | 686.0       | 20                    | 51 | 533 |                    |
| 500                      | 857                   | 108.0                       | 247.6          | 158.8                    | 209.6     | 749.5       | 20                    | 54 | 584 |                    |
| 600                      | 1041                  | 139.7                       | 292.1          | 203.2                    | 266.7     | 901.5       | 20                    | 67 | 692 |                    |



**FORGED FLANGES DIMENSIONS**

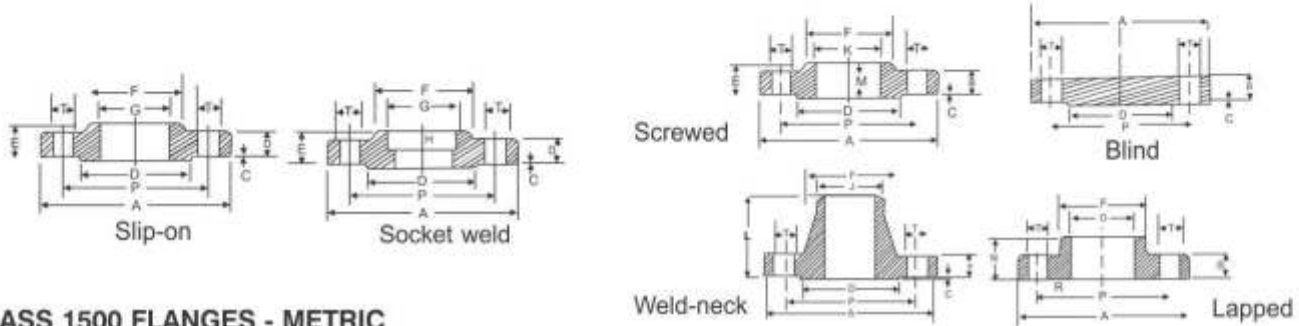

**CLASS 1500 FLANGES - METRIC**

| N.B. | A    | B     | C   | D   | E   | F   | G    | H    | J     | K     | L   | M  | N   | O     | P     | R    | T    | No. of Holes |
|------|------|-------|-----|-----|-----|-----|------|------|-------|-------|-----|----|-----|-------|-------|------|------|--------------|
| 15   | 121  | 22.2  | 6.4 | 35  | 32  | 38  | 22.4 | 9.5  | 21.3  | 23.5  | 60  | 22 | 32  | 23.0  | 82.6  | 3.0  | 22.2 | 4            |
| 20   | 130  | 25.4  | 6.4 | 43  | 35  | 44  | 27.7 | 11.0 | 26.7  | 29.0  | 70  | 25 | 35  | 28.0  | 88.9  | 3.0  | 22.2 | 4            |
| 25   | 149  | 28.6  | 6.4 | 51  | 41  | 52  | 34.5 | 12.5 | 33.4  | 36.0  | 73  | 29 | 41  | 35.0  | 101.6 | 3.0  | 25.4 | 4            |
| 32   | 159  | 28.6  | 6.4 | 64  | 41  | 64  | 43.2 | 14.5 | 42.2  | 44.5  | 73  | 30 | 41  | 43.5  | 111.1 | 5.0  | 25.4 | 4            |
| 40   | 178  | 31.8  | 6.4 | 73  | 44  | 70  | 49.5 | 16.0 | 48.3  | 50.5  | 83  | 32 | 44  | 50.0  | 123.8 | 6.5  | 28.6 | 4            |
| 50   | 216  | 38.1  | 6.4 | 92  | 57  | 105 | 62.0 | 17.5 | 60.3  | 63.5  | 102 | 38 | 57  | 62.5  | 165.1 | 8.0  | 25.4 | 8            |
| 65   | 244  | 41.3  | 6.4 | 105 | 64  | 124 | 74.7 | 19.0 | 73.0  | 76.0  | 105 | 48 | 64  | 75.0  | 190.5 | 8.0  | 28.6 | 8            |
| 80   | 267  | 47.6  | 6.4 | 127 | 73  | 133 | --   | --   | 88.9  | 92.0  | 117 | 51 | 73  | 91.5  | 203.2 | 9.5  | 31.8 | 8            |
| 100  | 311  | 54.0  | 6.4 | 157 | 91  | 162 | --   | --   | 114.3 | 118.0 | 124 | 57 | 91  | 17.0  | 241.3 | 11.0 | 34.9 | 8            |
| 125  | 375  | 73.0  | 6.4 | 186 | 105 | 197 | --   | --   | 141.3 | 145.0 | 156 | 64 | 105 | 145.0 | 292.1 | 11.0 | 41.3 | 8            |
| 150  | 394  | 82.6  | 6.4 | 216 | 119 | 229 | --   | --   | 168.3 | 171.0 | 171 | 70 | 119 | 171.0 | 317.5 | 12.5 | 38.1 | 12           |
| 200  | 483  | 92.1  | 6.4 | 270 | 143 | 292 | --   | --   | 219.1 | 222.0 | 213 | 76 | 143 | 222.0 | 393.7 | 12.5 | 44.4 | 12           |
| 250  | 584  | 108.0 | 6.4 | 324 | 159 | 368 | --   | --   | 273.0 | 276.0 | 254 | 84 | 178 | 277.0 | 482.6 | 12.5 | 50.8 | 12           |
| 300  | 673  | 123.8 | 6.4 | 381 | 181 | 451 | --   | --   | 323.9 | 329.0 | 283 | 92 | 219 | 328.0 | 571.5 | 12.5 | 54.0 | 16           |
| 350  | 749  | 133.4 | 6.4 | 413 | --  | 495 | --   | --   | 356.6 | --    | 298 | -- | 241 | 360.0 | 635.0 | 12.5 | 60.3 | 16           |
| 400  | 826  | 146.1 | 6.4 | 470 | --  | 552 | --   | --   | 406.4 | --    | 311 | -- | 260 | 411.0 | 704.8 | 12.5 | 6.7  | 16           |
| 450  | 914  | 161.9 | 6.4 | 533 | --  | 597 | --   | --   | 457.2 | --    | 327 | -- | 276 | 462.0 | 774.7 | 12.5 | 73.0 | 16           |
| 500  | 984  | 178.0 | 6.4 | 584 | --  | 641 | --   | --   | 508.0 | --    | 356 | -- | 292 | 514.0 | 831.8 | 12.5 | 79.4 | 16           |
| 600  | 1168 | 203.0 | 6.4 | 692 | --  | 762 | --   | --   | 609.6 | --    | 406 | -- | 330 | 616.0 | 990.6 | 12.5 | 92.0 | 16           |

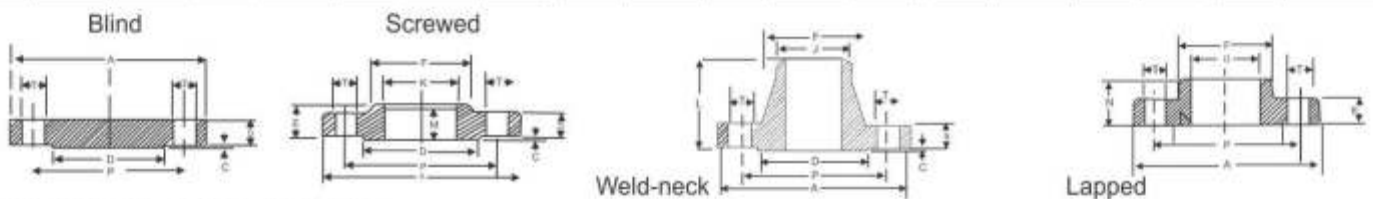

**CLASS 2500 FLANGES - METRIC**

| N.B. | A   | B     | C   | D   | E   | F   | G  | H  | J     | K     | L   | M   | N   | O     | P     | R    | T    | No. of Holes |
|------|-----|-------|-----|-----|-----|-----|----|----|-------|-------|-----|-----|-----|-------|-------|------|------|--------------|
| 15   | 133 | 30.2  | 6.4 | 35  | 40  | 43  | -- | -- | 21.3  | 23.5  | 73  | 29  | 40  | 23.0  | 88.9  | 3.0  | 22.2 | 4            |
| 20   | 140 | 31.7  | 6.4 | 43  | 43  | 51  | -- | -- | 26.7  | 29.0  | 79  | 32  | 43  | 28.0  | 95.2  | 3.0  | 22.2 | 4            |
| 25   | 159 | 34.9  | 6.4 | 51  | 48  | 57  | -- | -- | 33.4  | 35.0  | 89  | 35  | 48  | 35.0  | 107.9 | 3.0  | 25.4 | 4            |
| 32   | 184 | 38.1  | 6.4 | 64  | 52  | 73  | -- | -- | 42.2  | 44.5  | 95  | 38  | 52  | 43.5  | 130.2 | 5.0  | 28.6 | 4            |
| 40   | 203 | 44.4  | 6.4 | 73  | 60  | 79  | -- | -- | 48.3  | 50.5  | 111 | 44  | 60  | 50.0  | 146.0 | 6.5  | 31.8 | 4            |
| 50   | 235 | 50.8  | 6.4 | 92  | 70  | 95  | -- | -- | 60.3  | 63.5  | 127 | 51  | 70  | 62.5  | 171.4 | 8.0  | 28.6 | 8            |
| 65   | 267 | 57.1  | 6.4 | 105 | 79  | 114 | -- | -- | 73.0  | 76.0  | 143 | 57  | 79  | 75.5  | 196.8 | 8.0  | 31.8 | 8            |
| 80   | 305 | 66.7  | 6.4 | 127 | 92  | 133 | -- | -- | 88.9  | 92.0  | 168 | 64  | 92  | 91.5  | 228.6 | 9.5  | 34.9 | 8            |
| 100  | 356 | 76.2  | 6.4 | 157 | 108 | 165 | -- | -- | 114.3 | 118.0 | 190 | 70  | 108 | 117.0 | 273.0 | 11.0 | 41.3 | 8            |
| 125  | 419 | 92.1  | 6.4 | 186 | 130 | 203 | -- | -- | 141.3 | 145.0 | 229 | 76  | 130 | 145.0 | 323.8 | 11.0 | 47.6 | 8            |
| 150  | 483 | 108.0 | 6.4 | 216 | 152 | 235 | -- | -- | 168.3 | 171.0 | 273 | 83  | 152 | 171.0 | 368.3 | 12.5 | 54.0 | 8            |
| 200  | 552 | 127.0 | 6.4 | 270 | 178 | 305 | -- | -- | 219.1 | 222.0 | 318 | 95  | 178 | 222.0 | 438.1 | 12.5 | 54.0 | 12           |
| 250  | 673 | 165.1 | 6.4 | 324 | 229 | 375 | -- | -- | 273.0 | 276.0 | 419 | 108 | 229 | 277.0 | 539.7 | 12.5 | 66.7 | 12           |
| 300  | 762 | 184.1 | 6.4 | 381 | 254 | 441 | -- | -- | 323.9 | 329.0 | 464 | 121 | 254 | 328.0 | 619.1 | 12.5 | 73.0 | 12           |

\*Minimum length.





## HOUSE OF STAINLESS STEEL

Mob.: +91-9962492282 / 9884730542

✉ dbalajipurohit2008@yahoo.in 🌐 www.dbpipefittings.in



# D BALAJI PIPE FITTINGS



## FORGED FITTINGS

### Stainless Steel & Duplex Steel

Stainless Steel : ASTM A 182F - 304/304H/304L/316/316H/316/316Ti  
309, 310, 317L, 321, 347, 904L

Duplex & Super Duplex : ASTM A182 - F51, F53, F55

### Hi-Nickel & Titanium

#### Hi-Nickel

Nickel : ASTM B 564 N02200, N02201

Inconel : ASTM B 564 N06600, N06601, N06617  
ASTM B 564 N07718, ASTM B 564 N06625

Incoloy : ASTM B 564 N08800, N08810  
ASTM B 564, N08825, ASTM B 564 N08020

Hastelloy : ASTM B 564 N10276, N06022  
ASTM B 564 N10665, ASTM B 564 No6455

#### Titanium

Commercially : ASTM B 381

Titanium Pure Gr.1 R 56250 (CP4) Gr.2 R 50400 (CP3)  
Gr.3 R 50550 (CP2) Gr.4 R 50700 (CP1)  
Gr.7 R 52400 Gr.11 R 52250

Titanium Alloys : ASTM B 381  
Gr.5 R 56400 (6Al-4V) Gr.23 R 56401 (6Al-4V-ELI)  
Gr.12 R 53400

#### Cupro Nickel

ASTM B 151 C70600 (90:10), ASTM B 151 C71500 (70:30)

### Monel

ASTM B 564 N04400, N05500

### Alloy Steel, Carbon Steel

Alloy Steel : ASTM A 182 F 5, F 9, F 11,  
F 12, F 22, F 91

Carbon Steel : A105

Low Temp. CS : ASTM A - 350 Lf2

Other Service : Hot Dip Galvanizing, Sand Blasting

### Size

15NB To 100NB (Socket Weld & Threaded)

### Class

3000#, 6000#, 9000#, In ANSI B 16.11

### Types

|                     |          |
|---------------------|----------|
| Elbow (45 & 90 Deg) | Coupling |
| Tee                 | Cap      |
| Union               | Plug     |
| Cross               | Bushing  |
| Swage Nipple        | Boss     |

### Test Certificate

Manufacturer Test Certification (En 3.1 & 3.2, IBR Test Certificate)

### Specializing in :

#### Hi-Nickel & Stainless Steel Series

Inconel<sup>®</sup>, Incoloy<sup>®</sup>, Monel<sup>®</sup>, Hastelloy<sup>®</sup>, Duplex<sup>®</sup>, are Registered Trade Marks of their Respective Owners.



**DIMENSION IN MM OF FORGED SCREWED FITTINGS TO ANSI B-16.11 THREADED TO ASA B 2.1**

90° ELBOWS

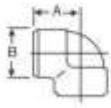

TEE

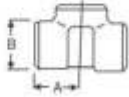

45° ELBOW



UNION

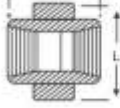

COUPLING

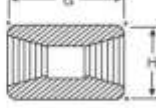

PIPE CAP

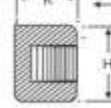

BUSHING

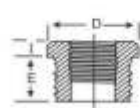

HEX HEAD PLUG

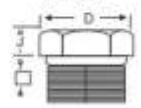

HALF COUPLING = G/2

| NOM BORE | PIPE O.D. | 3000 L.B.S. |     |    |     |     |    | COMMON FACTORS |    |     |    |    |     | 6000 L.B.S. |     |    |     |     |    |
|----------|-----------|-------------|-----|----|-----|-----|----|----------------|----|-----|----|----|-----|-------------|-----|----|-----|-----|----|
|          |           | A           | B   | C  | G   | H   | K  | D              | E  | F   | I  | J  | L   | A           | B   | C  | G   | H   | K  |
| 1/8"     | 10.3      | 21          | 22  | 17 | 32  | 16  | 19 | 11             | 10 | 40  | -  | 6  | -   | 25          | 25  | 19 | 32  | 22  | -  |
| 1/4"     | 13.7      | 25          | 25  | 19 | 35  | 19  | 25 | 16             | 11 | 43  | 3  | 6  | 32  | 29          | 33  | 22 | 35  | 25  | 27 |
| 3/8"     | 17.2      | 29          | 33  | 22 | 38  | 22  | 25 | 17.5           | 13 | 48  | 4  | 8  | 38  | 33          | 38  | 25 | 38  | 32  | 27 |
| 1/2"     | 21.3      | 33          | 38  | 25 | 48  | 29  | 32 | 22             | 15 | 51  | 5  | 8  | 46  | 38          | 46  | 29 | 48  | 38  | 33 |
| 3/4"     | 26.7      | 38          | 46  | 29 | 51  | 35  | 37 | 27             | 16 | 57  | 6  | 10 | 51  | 44          | 56  | 33 | 51  | 44  | 38 |
| 1"       | 33.4      | 44          | 56  | 33 | 60  | 44  | 41 | 35             | 19 | 64  | 6  | 10 | 60  | 51          | 62  | 35 | 60  | 57  | 43 |
| 1 1/4"   | 42.2      | 51          | 62  | 35 | 67  | 57  | 44 | 44.5           | 21 | 70  | 7  | 14 | 72  | 60          | 75  | 43 | 67  | 64  | 46 |
| 1 1/2"   | 48.3      | 60          | 75  | 43 | 79  | 64  | 44 | 51             | 21 | 79  | 8  | 16 | 80  | 64          | 84  | 44 | 79  | 76  | 48 |
| 2"       | 60.3      | 64          | 84  | 45 | 86  | 76  | 48 | 63.5           | 22 | 88  | 9  | 17 | 94  | 83          | 102 | 52 | 86  | 92  | 51 |
| 2 1/2"   | 73.02     | 83          | 102 | 52 | 92  | 92  | 60 | 76             | 27 | 118 | 10 | 21 | 122 | 95          | 121 | 64 | 92  | 108 | 64 |
| 3"       | 89.0      | 95          | 121 | 64 | 108 | 108 | 65 | 89             | 29 | 121 | 10 | 25 | 140 | 106         | 146 | 79 | 108 | 127 | 68 |
| 4"       | 114.5     | 114         | 152 | 79 | 121 | 140 | 68 | 117.5          | 32 | 150 | 13 | 25 | 180 | 114         | 152 | 79 | 121 | 159 | 75 |

**SOCKET WELD FITTING TO ANSI B-16.11**

90° ELBOWS

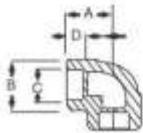

TEE

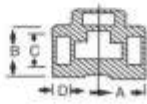

45° ELBOW



UNION

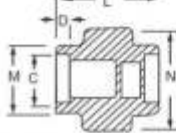

COUPLING

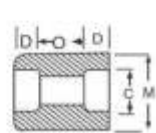

REDUCER

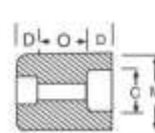

HALF COUPLING

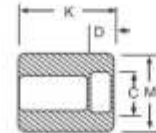

CAP

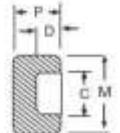

| NOM BORE | PIPE O.D. | 3000 L.B.S. |      |    |    |     |       |     |      |    | COMMON FACTORS |      |      |      | 6000 L.B.S. |     |    |    |     |
|----------|-----------|-------------|------|----|----|-----|-------|-----|------|----|----------------|------|------|------|-------------|-----|----|----|-----|
|          |           | A           | B    | K  | J  | L   | M     | N   | P    | Q  | Cmin           | Dmin | Omin | Omax | A           | B   | M  | K  | N   |
| 1/8"     | 10.3      | 22          | 18.5 | 26 | 16 | 40  | 17.3  | 32  | 17.5 | 10 | 10.7           | 10   | 5    | 8    | 22          | 22  | 20 | 25 | 46  |
| 1/4"     | 13.7      | 22          | 22   | 26 | 18 | 43  | 21.2  | 32  | 17.5 | 10 | 14.1           | 10   | 5    | 8    | 27          | 25  | 24 | 25 | 51  |
| 3/8"     | 17.2      | 25          | 25   | 26 | 19 | 48  | 25.4  | 36  | 19   | 10 | 17.6           | 10   | 3    | 9    | 27          | 28  | 28 | 26 | 60  |
| 1/2"     | 21.3      | 27          | 32   | 30 | 21 | 51  | 31    | 43  | 22   | 10 | 21.7           | 10   | 6    | 13   | 31          | 34  | 34 | 31 | 72  |
| 3/4"     | 26.7      | 34          | 38   | 36 | 24 | 57  | 37    | 50  | 25   | 13 | 27             | 13   | 6    | 13   | 37          | 42  | 41 | 35 | 80  |
| 1"       | 33.4      | 37          | 46   | 40 | 25 | 64  | 45.2  | 60  | 27   | 13 | 33.8           | 13   | 9    | 17   | 42          | 50  | 50 | 40 | 94  |
| 1 1/4"   | 42.2      | 42          | 56   | 40 | 29 | 70  | 55    | 70  | 30   | 13 | 42.6           | 13   | 9    | 17   | 47          | 59  | 58 | 41 | 100 |
| 1 1/2"   | 48.3      | 47          | 62   | 40 | 30 | 79  | 61.4  | 78  | 32   | 13 | 48.7           | 13   | 9    | 17   | 53          | 67  | 55 | 43 | 122 |
| 2"       | 60.3      | 56          | 75   | 52 | 37 | 89  | 75    | 95  | 38   | 13 | 61.2           | 16   | 15   | 23   | 59          | 84  | 83 | 55 |     |
| 2 1/2"   | 73.02     | 60          | 92   | 52 | 48 | 114 | 91.3  | 125 | 38   | 16 | 73.8           | 16   | 14   | 24   |             | 102 |    | 56 |     |
| 3"       | 89.00     | 76          | 110  | 52 | 51 | 127 | 108.8 | 140 | 44   | 16 | 89.8           | 16   | 14   | 24   |             | 121 |    | 58 |     |
| 4"       | 114.50    | 88          | 137  | 58 |    | 150 | 136.9 |     | 48   | 19 | 115.5          | 19   | 14   | 24   |             | 152 |    | 64 |     |

DIMENSIONS AND OTHERS SPECIFICATIONS AS PER CUSTOMERS REQUIREMENTS ARE AVAILABLE ON REQUEST





## PIPES & TUBES

### **Stainless Steel & Duplex Steel**

Stainless Steel : ASTM A 312, 249, 269, 312, 358 - TP 304, 304L, 316L, 316Ti, 309, 310, 317, 317L, 321, 347, 904L, SMO 254

Duplex & : Standard

Super Duplex : ASTM A 789, 790 - UNS S31803, S32205 (2205)

Lean

ASTM A 798, 790 - UNS S32304 (2304)

Super Duplex

ASTM 789, 790, - UNS S32750 (2507)

UNS S32760 (Zeron 100)

### **Hi-Nickel & Titanium**

#### **Hi-Nickel**

Nickel : ASTM B 161, 622 - N02200, N02201

Inconel : ASTM B 167, 517, 163 - N06600, N06601, N06617  
ASTM B 444 - N07718, ASTM B 444, 705 - N06625

Incoloy : ASTM B 407, 154, 163, 515 - N08800, N08810  
ASTM B 423 - N08825, ASTM B 729, 464, 468-N08020

Hastelloy : ASTM B 622, 619, 626 - N10276, N06022,  
N10665, N06455

#### **Titanium**

Commercially : ASTM B 861, 862, 338

Pure : Gr.1 R 56250 (CP4) Gr.2 R 50400 (CP3)  
Gr.3 R 50550 (Cp2) Gr.4 R 50700 (Cp1)  
Gr.7 R 52400 Gr.11 R 52250

Alloys : ASTM B 861, 862, 338  
Gr.5 R 56400 (6Al-4V)  
Gr.23 R 56401 (6Al-4V-ELI)  
Gr.12 R 53400

### **Cupro Nickel**

ASTM B466, B111 - C70600 (90:10), C71500 (70:30)

### **Monel**

ASTM B165, B 725, B163 - N04400, N05500

### **Alloy Steel, Carbon Steel & LTCS**

Alloy Steel Pipes : ASTM A335 GR. P5, P9, P11, P22 & P91

Alloy Steel Tubes : ASTM A 213 - T-11, T-12, T-22  
: T-5, T-9 etc.

Carbon Steel Pipes : ASTM A 106 Gr. B, ASTM A53

Carbon Steel Tubes : BS 3059 Gr. 360 / 440, SA 179,  
SA / ASTM A210 Gr. A1

Low Temp. (LTCS) : ASTM A 333 Gr. 6

Line Pipe : API 5L, X 42, 46, 52, 56, 60, 70

Mild Steel & Galvanized: IS 1239, IS 3589

#### **Size**

Pipes : 1/4" to 48"

Schedule : Sch. 5 to Sch. XXS

Tubes : 6 mm OD to 219.08 mm OD

Thickness : 0.6mm-10mm-Gauge : SWG/BWG  
to 10 SWG/BWG

Form : Round, Square, Rectangle, Coil, 'U' Shape

Length : Standard Length & Cut Length

#### **Test Certificate**

Manufacturer Test Certification (En 3.1 & 3.2, IBR Test Certificate)

#### **Specializing in :**

Large Diameter CS Pipes & Duplex Steel

Inconel®, Incoloy®, Monel®, Hastelloy®, Duplex®,

are Registered Trade Marks of their Respective Owners.



**PIPES & TUBES**



Items dealt by us are Guaranteed and we provide Mill Test Certificate / Government Approved Lab Test Certificate with the supplies. Third Party Inspection by any Reputed Organization like LLOYDS, EIL, PDIL, BVIS, DNV etc. is accepted by us. These Listed items most of which we can supply Ex-stock or within a very Short Delivery period at very competitive rate with specified material & Quality Assurance plan therefore we request you to honour of being on your list of approved Suppliers.

**PIPE & TUBE**

**Manufacture**

Our company is India's largest manufacturer of stainless steel in 200 series, 300 series (including Stainless Steel) ASTM A312, 249, 269, 312, 358, TP 304, 304L, 316L, 310, 321 series and duplex stainless steel grades. Our product range includes Stainless Steel Seamless Pipe / Semi Seamless Pipe & ERW Pipe. Combining an experience of over four decades, a clear focus on customer needs, cross market expertise, a wide range of products and modern technology has been the mainstay of our success. All the products manufactured by authentic raw material by Jindal / Essar / SAIL and all other brands.



Seamless Pipe & Tube  
 Welded Pipe & Tube  
 Thick-walled Pipe & Tube  
 Capillary Tube  
 Sanitary Pipe & Tube  
 Square Pipe & Tube  
 Rectangle Pipe & Tube  
 Cold Tube







**STAINLESS STEEL PIPE DIMENSION AS PER ASTM AND WEIGHT KG. PER MTR. (ANSI B 36.19)**

| Nominal Bore |       | Outside Diameter | Schedule 5S |                | Schedule 10S |                | Schedule 20S |                | Schedule 40S |                | Schedule 80S |                | Schedule 160S |                | Schedule XXS |                |
|--------------|-------|------------------|-------------|----------------|--------------|----------------|--------------|----------------|--------------|----------------|--------------|----------------|---------------|----------------|--------------|----------------|
| mm           | Inch  | mm               | Wt mm       | Weight (Kg/mt) | Wt mm        | Weight (Kg/mt) | Wt mm        | Weight (Kg/mt) | Wt mm        | Weight (Kg/mt) | Wt mm        | Weight (Kg/mt) | Wt mm         | Weight (Kg/mt) | Wt mm        | Weight (Kg/mt) |
| 3            | 1/8   | 10.3             | 1.24        | 0.276          | 1.24         | 0.28           | 1.5          | 0.33           | 1.73         | 0.37           | 2.41         | 0.47           | -             | -              | -            | -              |
| 6            | 1/4   | 13.7             | 1.24        | 0.390          | 1.65         | 0.49           | 2.00         | 0.58           | 2.24         | 0.631          | 3.02         | 0.80           | -             | -              | -            | -              |
| 10           | 3/8   | 17.1             | 1.24        | 0.490          | 1.65         | 0.63           | 2.00         | 0.74           | 2.31         | 0.845          | 3.20         | 1.10           | -             | -              | -            | -              |
| 15           | 1/2   | 21.3             | 1.65        | 0.800          | 2.11         | 1.00           | 2.30         | 1.07           | 2.77         | 1.27           | 3.75         | 1.62           | 4.75          | 1.94           | 7.47         | 2.55           |
| 20           | 3/4   | 26.7             | 1.65        | 1.03           | 2.11         | 1.28           | 2.55         | 1.52           | 2.87         | 1.68           | 3.91         | 2.20           | 5.54          | 2.89           | 7.82         | 3.63           |
| 25           | 1     | 33.4             | 1.65        | 1.30           | 2.77         | 2.09           | 2.55         | 1.94           | 3.38         | 2.50           | 4.55         | 3.24           | 6.35          | 4.24           | 9.09         | 5.45           |
| 32           | 1.1/4 | 42.2             | 1.65        | 1.65           | 2.77         | 2.70           | 3.00         | 2.90           | 3.56         | 3.38           | 4.85         | 4.47           | 6.35          | 5.61           | 9.70         | 7.77           |
| 40           | 1.1/2 | 48.3             | 1.65        | 1.91           | 2.77         | 3.11           | 3.00         | 3.55           | 3.68         | 4.05           | 5.08         | 5.41           | 7.14          | 7.25           | 10.16        | 9.54           |
| 50           | 2     | 60.3             | 1.65        | 2.40           | 2.77         | 3.93           | 3.00         | 4.24           | 3.91         | 5.44           | 5.54         | 7.48           | 8.74          | 11.1           | 11.07        | 13.44          |
| 65           | 2.1/2 | 73.0             | 2.11        | 3.69           | 3.05         | 5.26           | 4.00         | 6.81           | 5.16         | 8.63           | 7.01         | 11.4           | 9.53          | 14.9           | 14.2         | 20.39          |
| 80           | 3     | 88.9             | 2.11        | 4.51           | 3.05         | 6.45           | 4.00         | 8.37           | 5.49         | 11.30          | 7.62         | 15.2           | 11.1          | 21.3           | 15.24        | 27.65          |
| 100          | 4     | 114.3            | 2.11        | 5.84           | 3.05         | 8.36           | 4.50         | 12.18          | 6.02         | 16.07          | 8.56         | 22.3           | 13.49         | 33.54          | 17.12        | 41.03          |
| 125          | 5     | 141.3            | 2.77        | 9.47           | 3.40         | 11.57          | 5.00         | 16.80          | 6.55         | 21.8           | 9.53         | 31.97          | 15.88         | 49.11          | 19.05        | 57.43          |
| 150          | 6     | 168.3            | 2.77        | 11.32          | 3.40         | 13.84          | 6.35         | 25.36          | 7.11         | 28.3           | 10.97        | 42.7           | 18.2          | 67.56          | 21.95        | 79.22          |
| 200          | 8     | 219.1            | 2.77        | 14.79          | 3.76         | 19.96          | 6.35         | 33.31          | 8.18         | 42.6           | 12.7         | 64.6           | 23.0          | 111.2          | 22.23        | 107.8          |
| 250          | 10    | 273.1            | 3.40        | 22.63          | 4.19         | 27.78          | 6.35         | 41.77          | 9.27         | 60.5           | 12.7         | 96.0           | 28.6          | 172.4          | 25.40        | 155.15         |
| 300          | 12    | 323.9            | 3.96        | 31.25          | 4.57         | 36.00          | 6.35         | 49.7           | 9.52         | 73.88          | 12.7         | 132.0          | 33.32         | 238.76         | 25.40        | 186.97         |
| 350          | 14    | 355.6            | 3.96        | 34.36          | 4.78         | 41.3           | 7.92         | 67.80          | 11.13        | 94.59          | 19.05        | 158.08         | 35.71         | 281.70         | -            | -              |
| 400          | 16    | 406.4            | 4.19        | 41.56          | 4.78         | 47.29          | 7.92         | 77.83          | 12.7         | 123.30         | 21.41        | 203.33         | 40.46         | 365.11         | -            | -              |
| 450          | 18    | 457.2            | 4.19        | 46.80          | 4.78         | 53.42          | 7.92         | 87.71          | 14.27        | 155.80         | 23.8         | 254.36         | 45.71         | 466.40         | -            | -              |
| 500          | 20    | 508.0            | 4.78        | 59.25          | 5.54         | 68.71          | 9.53         | 117.14         | 15.09        | 183.42         | 26.19        | 311.2          | 49.99         | 564.68         | -            | -              |
| 600          | 24    | 609.6            | 5.54        | 82.47          | 6.35         | 94.45          | 9.53         | 141.12         | 17.48        | 255.41         | 30.96        | 442.08         | 59.54         | 808.22         | -            | -              |



## COMPRESSION TUBE FITTINGS

### Accessories



Front Ferrule



Back Ferrule



Ferrule Nut

### Tube to Male Connection



Male Connector



Male Elbow



Male Bulkhead Connector



Male Run Tee

### Tube to Female Connection



Female Connector



Female Elbow



Female Bulkhead Connector



Female Run Tee



Female Branch Tee

### Tube to Union Connection



Union



Union Elbow



Union Tee



Union Cross



Bulkhead Union



Reducing Union

### Instrumentation Pipe Fittings



Male Tee



Female Tee



Street Tee



Branch Tee



Female Cross



Male Elbow



Female Elbow



Street Elbow



Adapter



Bushing



Hex Coupling



Reducing Hex Coupling



Hex Nipple



Reducing Hex Nipple

### SPECIFICATION

Available Grade : Nickel Alloys ( Inconel / Monel / Hastelloy / Nickel / SMO254) Cupro-Nickel / Duplex / Super Duplex / Titanium / Stainless Steel

Size : 1/16" OD to 2" OD & 2 MM OD to 50 MM OD

Perssure Rating : Upto 6000 PSI

Thread : NPT, BSP, BSPT, BSPP, UNF, ISO, SAF, Etc.

Temperature Rating: Upto 426°C

PTFE Standard : ASTM A1710, ASTM D3294

Certification : En 10204 Type 3.1



Hex Plug



Female Cap





## FASTENERS



### TYPE OF BOLTS

- Hex Head Bolt
- Socket Cap Screw
- Carriage Bolt
- Flange Bolt
- Elevator Bolt
- Machine Bolt
- Grub Screw
- Set Screw
- Anchor Bolt
- Eye Bolt
- Hanger Bolt
- U Bolt
- J Bolt

### TYPE OF NUTS

- Hex Nut
- Heavy Hex Nut
- Cap Nut
- Coupling Nut
- High Nut
- Flange Lock Nut
- Nylon Lock Nut
- Slotted Nut
- Custom Nut
- Wing Nut
- Jam Nut
- T Nut

### TYPE OF SCREWS

- Self Drilling Screw
- Self Tapping Screw
- Machine Screw
- Particle Board Screw
- Roofing Screw
- Construction Screw
- Furniture Screw
- Wing Screw
- Cap Screw

### TYPE OF WASHERS

- Flat Washer
- Spring Washer
- Dome Washer
- Countersunk Washer
- Hex Washer
- Lock Washer
- Square Washer
- Customized Washer

**Stainless Steel** : AISI 304,304L,316,316L, 310, 317, 317L, 321, 347, 410, 420,904L etc.

**Alloy Steel** : 4.6, 5.6, 6.6, 8.8, 10.9 & 12.9 / 'R', 'S', 'T' Conditions.

**Carbon Steel** : Bare Condition, Galvanized, Phosphetised, Cadium Plated, Hot Deep Galvanized, Bloodied, Nickel Chrome Plated,etc.

**High Nickel Alloy** : Monel, Nickel, Inconel, Hastelloy

**Others** : Copper, Brass, Bronze, Titanium, Tantalum, Bismuth, Aluminium, High Speed Steel, Zinc, Lead, etc.

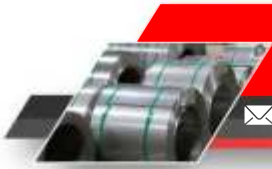

# HOUSE OF STAINLESS STEEL

Mob.: +91-9962492282 / 9884730542

✉ dbalajipurohit2008@yahoo.in 🌐 www.dbpipefittings.in



## D BALAJI PIPE FITTINGS

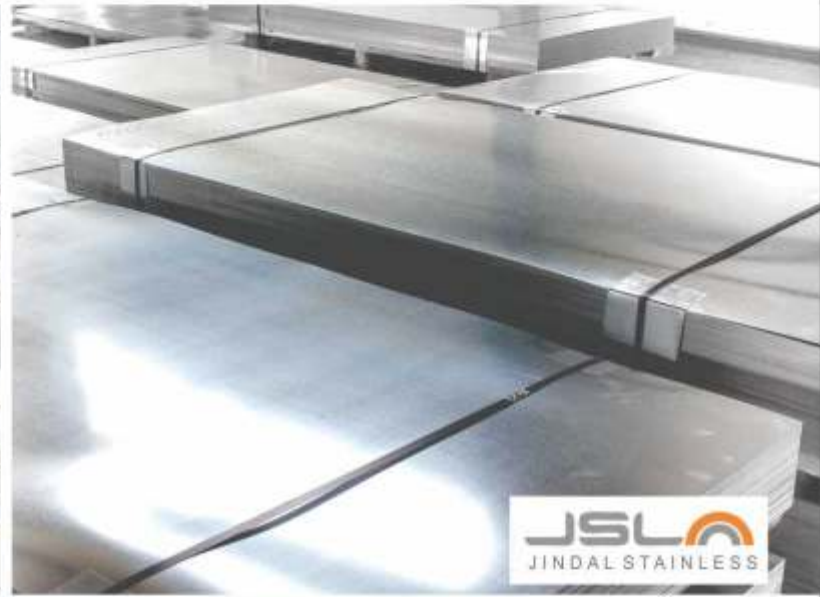

### SHEET / PLATE / COIL / SHIMS

#### Stainless Steel & Duplex Steel

- Stainless Steel : ASTM A 240, 304/304L/316/316L/316TI/309/310/  
317/317L/321/347/409/410/430/  
904L/SMO 254/AL6N
- Duplex & Super Duplex : Standard  
ASTM A240 - UNS S31803/S32205 (2205)  
Lean  
ASTM A240 - UNS S32304 (2304)  
Super Duplex  
ASTM A240 - UNS S32750 (2507)  
ASTM A240 - UNS S32760 (Zeron 100)

#### Hi-Nickel & Titanium

##### Hi-Nickel

- Nickel : ASTM B 162 N02200, N02201
- Inconel : ASTM B 168 N06600, N06601, N06617  
ASTM B 670 N07718, ASTM B 443 N06625
- Incoloy : ASTM B 409 N08800, N08810  
ASTM B 424 N08825, ASTM B 462 N08020
- Hastelloy : ASTM B 575 N10276, N06022  
ASTM B 333 N10665

##### Titanium

- Commercially : ASTM B 265
- Titanium Pure : Gr.1 R 56250 (CP4) Gr.2 R 50400 (CP3)  
Gr.3 R 50550 (CP2) Gr.4 R 50700 (CP1)  
Gr.7 R 52400
- Titanium Alloys : ASTM B 265  
Gr.5 R 56400 (6Al-4V)  
Gr.23 R 56401(6Al-4V-ELI)  
Gr.12 R 53400

##### Cupro Nickel

- ASTM B 171 C70600 (90:10), C71500 (70:30)

#### Monel

- ASTM B127 N04400, DIN N05500

#### Alloy Steel, Carbon Steel / Mild Steel

- Alloy Steel Pipe : ASTM A387 Gr. 11, 12, 22, 5, 91 (CL 1/2)  
WP 12, WP 22, WP 91
- Carbon Steel : ASTM A 36, S275 JR, IS 2062 Gr. A/B

#### Boiler Quality

- SA 516 Gr. 70

#### Hardox

- Hardox 400/500

#### Size

- Sheets : 0.5mm to 4mm Thk. in 1000 upto  
2000mm Width & 2000 upto 6000 Length
- Plates : 5mm to 100 mm Thk. in 1000 upto  
2000mm Width & 2000 upto 8000 Length
- Coils : 0.1mm Thk. to 12mm Thk. in 10mm upto  
1500 Width
- Foils : 0.01mm Thk. to 0.3mm Thk. in any Width
- Strips : 1mm Thk. to 100mm Thk. in 10mm upto  
Width & 1000 upto 6000 Length

#### Test Certificate

- Manufacturer Test Certification (En 3.1 & 3.2, IBR Test Certificate)

#### Specializing in :

##### Hi-Nickel & Stainless Steel Series

- Inconel\*, Incoloy\*, Monel\*, Hastelloy\*, Duplex\*,  
are Registered Trade Marks of their Respective Owners.



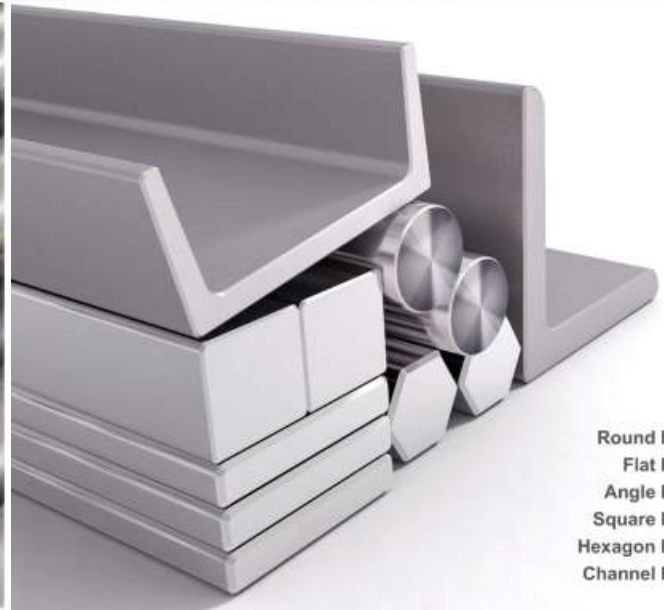

Round Bar  
Flat Bar  
Angle Bar  
Square Bar  
Hexagon Bar  
Channel Bar

## ROUND BARS & FLAT BARS

### Stainless Steel & Duplex Steel

Stainless Steel : ASTM A276, A479 - 304/304L/316/316L/316Ti/309/310/317/317L/321/347/409/410/430/904L/SMO 254  
Duplex & Super Duplex : Standard ASTM A276, A479 - UNS S31803/S32205 (2205) Lean UNS S32304 (2304) Super Duplex UNS S32750 (2507) UNS S32760 (Zeron 100)

### Hi-Nickel & Titanium

#### Hi-Nickel

Nickel : ASTM B160 - N02200, N02201  
Inconel : ASTM B166 - N06600, N06601, N06617  
ASTM B637 - N07718, ASTM B446 - N06625  
Incoloy : ASTM B408 - N08800, N08810  
ASTM B408 - N08825, ASTM B473 - N08020  
Hastelloy : ASTM B574 - N10276, ASTM B574 - N06022  
ASTM B335 - N10665

#### Titanium

Commercially : ASTM B348 - Gr.1 R 56250 (CP4) Gr.2 R 50400 (CP3)  
Gr.3 R 50550 (CP2) Gr.4 R 50700 (CP1)  
Gr.7 R 52400  
Titanium Alloys : ASTM B348 - Gr.5 R 56400 (6Al-4V)  
Gr.23 R 56401(6Al-4V-ELI)  
Gr.12 R 53400

#### Cupro Nickel

ASTM B151 - C70600 (90:10), C71500 (70:30)

### Monel

ASTM B164 - N04400, ASTM B865 - N05500

### Alloy Steel, Carbon Steel / Mild Steel

Alloy Steel : ASTM A182 - F 5, F 9, F 11, F 12, F 22, F 91  
Carbon Steel : A105

### Size

Size : 2 MM to 500 MM Dia  
Length : 500 MM to 6000 MM long and in cut to Size  
Form : Round, Square, Hex (A/F), Rectangle, Flat etc.  
Finish : Bright, Polish & Black

### Test Certificate

Manufacturer Test Certification (En 3.1 & 3.2, IBR Test Certificate)

### Specializing in :

#### Hi-Nickel & Stainless Steel Series

Inconel<sup>®</sup>, Incoloy<sup>®</sup>, Monel<sup>®</sup>, Hastelloy<sup>®</sup>, Duplex<sup>®</sup>, are Registered Trade Marks of their Respective Owners.



**FORMULA**

- 1) WEIGHT OF STAINLESS STEEL PIPES & TUBES  
 $OD (mm) - W.T. (mm) \times W.T. (mm) \times 0.02466 = Kg. \text{ per Mtr.}$
- 2) SHEET WIDTH REQUIRED FOR ROLLED AND WELDED PIPES  
 $O.D. (mm) - THK (mm) \times 3.14 = \text{Sheet Width}$
- 3) WEIGHT OF STAINLESS STEEL SHEETS  
 $\text{Length (mtr.)} \times \text{Wdth (mtr.)} \times \text{Thk (mm)} \times 8 = \text{Kg Per Sheet}$
- 4) WEIGHT OF STAINLESS STEEL CIRCLE & BLANKS  
 $O.D. (mm) \times O.D. > (mm) \times \text{Thk (mm)} / 160/1000 = \text{Kg Per Pcs.}$
- 5) WEIGHT OF STAINLESS STEEL ROUNDS  
 $\text{Dia. (mm)} \times \text{Dia. (mm)} \times 0.00623 = \text{Per Mtr.}$
- 6) WEIGHT OF STAINLESS STEEL HEXAGONAL RODS  
 $\text{Dia. (mm)} \times \text{Dia. (mm)} \times 0.00679 = \text{Per Mtr.}$
- 7) WEIGHT OF STAINLESS STEEL SQUARE BARS  
 $\text{Dia. (mm)} \times \text{Dia. (mm)} \times 0.00787 = \text{Kg Per Mtr.}$
- 8) WEIGHT OF CARBON STEEL PIPES & TUBES  
 $O.D. (mm) - W.T. (mm) \times W.T. (mm) \times 0.02466 = \text{Kg. Per Mtr.}$
- 9) WEIGHT OF CARBON STEEL SHEETS - PLATES  
 $\text{Length (mtr.)} \times \text{Width (mtr.)} \times \text{Thk (mm)} \times 7.85 = \text{Kg. Per Sheet}$
- 10) WEIGHT OF COPPER PIPES  
 $O.D. (mm) - W.T. (mm) \times W.T. (mm) \times 0.0256 = \text{Kg. Per Mtr.}$
- 11) WEIGHT OF LEAD PIPES (appro.)  
 $O.D. (mm) - W.T. (mm) \times W.T. (mm) \times 0.0345 = \text{Per Mtr.}$
- 12) WEIGHT OF LEAD SHEETS (appro.)  
 $\text{Length (mtr.)} \times \text{Width (mtr.)} \times \text{Thk (mm)} \times 11.2 = \text{Kg. Per Sheet}$
- 13) WEIGHT OF ALLUMINIUM PIPES (appro.)  
 $O.D. (mm) - W.T. (mm) \times W.T. (mm) \times 0.0082 = \text{Kg. Per Mtr.}$
- 14) WEIGTH OF ALLUMINIUM SHEETS (appro.)  
 $\text{Length (mtr.)} \times \text{Width (mtr.)} \times \text{Thk (mm)} \times 2.66 = \text{Kg Per Sheet}$
- 15) MAKING OF PIPE FROM SHEET OR PLATE  
 $OD - \text{Thickness} \times 3.14 = \text{Width of Sheet or Plate}$





**APPLICATION INDUSTRIES**

- Natural Gas
- Water Disposal
- Chemical Engineering
- Cement Industries
- Refinery Plants
- Oil & Gas
- Power
- Ship Building

**THIRD PARTY INSPECTION**





# **D BALAJI** **PIPE FITTINGS**

**Stainless Steel UNS S30400 / S30403 Sheets, Plates, Coil,  
SS Sheets, Plates & Coil Stainless Steel Sheets, Plates & Coil**

**Supplier Stainless Steel DIN 1.4301 / 1.4306 /  
1.4307 Sheets, Plates & Coil Supplier**

D Balaji Pipe Fittings & Exporting of high quality stainless steel 304 sheets, stainless steel 304L plates, stainless steel 304 coils in thickness of 0.8 mm to 120 mm that have found extensive applications in various industries. We also deal in Nickel and Copper, Alloy, Stainless & Duplex Steel, Carbon & Alloy Steel are the materials which are used for designing of stainless steel sheets, plate and coil. We offer various grades of stainless steel plates & stainless steel sheets link SS 310 plates, SS 317 sheets & SS 321 plates etc.

**Factory : Pato Pandora Tatak Voki Rada Road, Magan Fest, Munchal, Maharashtra - 401 202.**

**Mobile : +91-9962492282 +91-9884730542 Whatsapp : +91-9444522558+91-6374260316**

**Email : dbalajipipes 2008@gmail.com / dbalajipurohit2008@yahoo.in / internationaldbalaji 2008@gmail.com**

**Web : [www.dbpipefittings.in](http://www.dbpipefittings.in)**